

# 500 Series Swivel Joints



## Operating Condition

Size Range : 25A~400A (1"~16")  
 Max. Pressure : 20kg/cm<sup>2</sup> (280PSI)  
 Max. Temperature :  
 100°C (210°F) NBR Packing  
 180°C (360°F) Viton Packing  
 Media : Air, Oil, Water

## Features

- Flange Type
- Double row steel balls supporting pressure compensation
- Extended service life by Precision processing

### FTKJ500

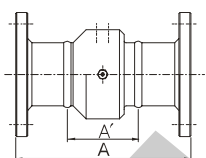

Type A

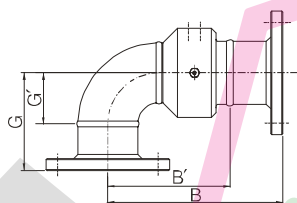

Type C

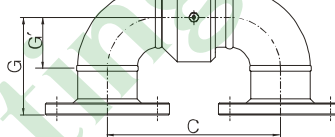

Type D

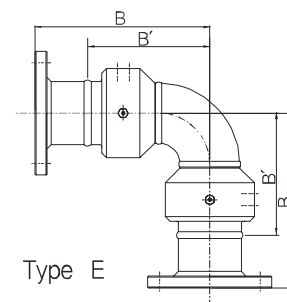

Type E

[unit : mm]

Nominal Size		A	A'	B	B'	C	G	G'
25A	1"	187	76	170	114	152	94	38.1
32A	1-1/4"	203	89	194	137	184	105	47.6
40A	1-1/2"	215	91	210	148	205	119	57.2
50A	2"	220	93	233	169	245	140	76.2
65A	2-1/2"	250	110	243	174	237	133	63.5
80A	3"	255	115	261	191	267	146	76.2
100A	4"	272	120	298	222	323	178	101.6
125A	5"	304	126	342	253	380	216	127
150A	6"	334	156	397	308	461	241	152.4
200A	8"	368	165	470	368	571	305	203.2
250A	10"	397	194	550	448	702	356	254
300A	12"	436	207	626	512	817	419	304.8
350A	14"	470	216	699	572	927	483	355.6
400A	16"	476	222	755	628	1035	533	406.4