

# 2200 Series Rotary Joints

[DUPLEX | STATIONARY SYPHON]

▼ FTKR2201 / FTKR2202

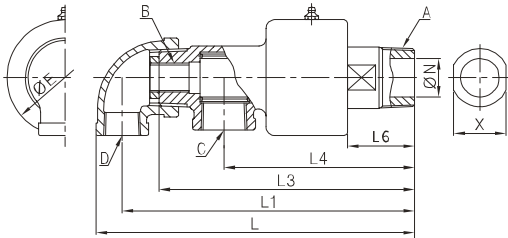

▼ FTKR2205

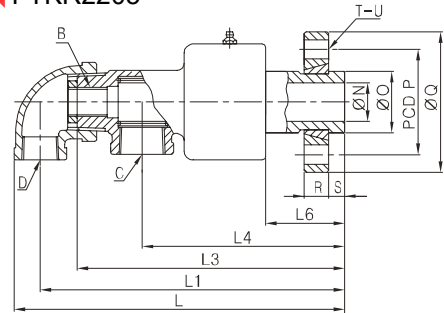

[DUPLEX | ROTARY SYPHON]

▼ FTKR2221 / FTKR2222

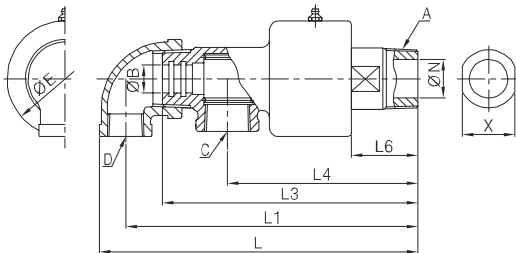

▼ FTKR2225

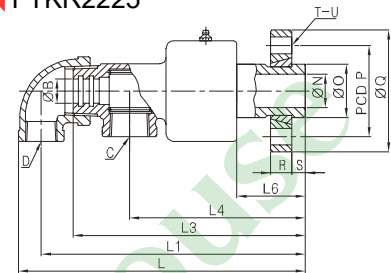

[unit : mm]

MODEL NO.		A	B	C	D	E	L	L1	L3	L4	L6	N	X	Wt				
PT [RH]	PT [LH]	(PT)	(PF,Ø)	(PT)	(PT)									(kg)				
FTKR2201-15A-6A	FTKR2202-15A-6A	1/2"	1/8"	1/2"	1/2"	51	162	147	129	96.5	35	13	21	0.8				
FTKR2221-15A-Ø9	FTKR2222-15A-Ø9	1/2"	9	1/2"	1/2"	51	162	147	129	96.5	35	13	21	0.8				
FTKR2201-20A-8A	FTKR2202-20A-8A	3/4"	1/4"	1/2"	1/2"	56	168	153	134	101.5	38	17	26	1				
FTKR2221-20A-Ø9, Ø13	FTKR2222-20A-Ø9, Ø13	3/4"	9,13	1/2"	1/2"	56	168	153	134	101.5	38	17	26	1				
FTKR2201-25A-10A	FTKR2202-25A-10A	1"	3/8"	3/4"	1/2"	66	182	166.5	145.5	108.5	38	22	30	1.5				
FTKR2221-25A-Ø13, Ø16	FTKR2222-25A-Ø13, Ø16	1"	13,16	3/4"	1/2"	66	182	166.5	145.5	108.5	38	22	30	1.5				
FTKR2201-32A-15A	FTKR2202-32A-15A	1-1/4"	1/2"	1"	3/4"	88	234	215	192	138	46	30	46	3.1				
FTKR2221-32A-Ø20	FTKR2222-32A-Ø20	1-1/4"	20	1"	3/4"	88	234	215	192	138	46	30	46	3.1				
FTKR2201-40A-20A	FTKR2202-40A-20A	1-1/2"	3/4"	1"	3/4"	88	234	215	192	138	46	35	46	3				
FTKR2221-40A-Ø20, Ø26	FTKR2222-40A-Ø20, Ø26	1-1/2"	20,26	1"	3/4"	88	234	215	192	138	46	35	46	3				
FTKR2201-50A-25A	FTKR2202-50A-25A	2"	1"	1-1/2"	1"	106	280	256	228	168	58	48	60	5.5				
FTKR2221-50A-Ø26, Ø32	FTKR2222-50A-Ø26, Ø32	2"	26,32	1-1/2"	1"	106	280	256	228	168	58	48	60	5.5				
FTKR2201-65A-32A	FTKR2202-65A-32A	2-1/2"	1-1/4"	2"	1-1/2"	127	336	306	271	194	64	60	75	10.4				
FTKR2221-65A-Ø32, Ø40, Ø48	FTKR2222-65A-Ø32, Ø40, Ø48	2-1/2"	32,40,48	2"	1-1/2"	127	336	306	271	194	64	60	75	10.4				
FTKR2201-80A-40A	FTKR2202-80A-40A	3"	1-1/2"	2"	1-1/2"	145	337	309	285	212	75	70	89	13				
FTKR2221-80A-Ø48	FTKR2222-80A-Ø48	3"	48	2"	1-1/2"	145	337	309	285	212	75	70	89	13				
MODEL NO.	B	C	D	E	L	L1	L3	L4	L6	N	O	P	Q	R	S	T	U	Wt
FLANGE	(PF,Ø)	(PT)	(PT)															(kg)
FTKR2205-15A-6A	1/8"	1/2"	1/2"	51	162	147	129	96.5	35	13	25	45	62	11	8	4	Ø9	1.1
FTKR2225-15A-Ø9	9	1/2"	1/2"	51	162	147	129	96.5	35	13	25	45	62	11	8	4	Ø9	1.1
FTKR2205-20A-8A	1/4"	1/2"	1/2"	56	172	157	138	105.5	42	17	30	54	74	13	8	4	Ø11	1.4
FTKR2225-20A-Ø9, Ø13	9,13	1/2"	1/2"	56	172	157	138	105.5	42	17	30	54	74	13	8	4	Ø11	1.4
FTKR2205-25A-10A	3/8"	3/4"	1/2"	66	189	173.5	152.5	115.5	45	22	35	60	80	14	9	4	Ø11	1.7
FTKR2225-25A-Ø13, Ø16	13,16	3/4"	1/2"	66	189	173.5	152.5	115.5	45	22	35	60	80	14	9	4	Ø11	1.7
FTKR2205-40A-20A	3/4"	1"	3/4"	88	243	224	201	147	55	35	50	75	96	16	9	4	Ø11	3.7
FTKR2225-40A-Ø20, Ø26	20,26	1"	3/4"	88	243	224	201	147	55	35	50	75	96	16	9	4	Ø11	3.7
FTKR2205-50A-25A	1"	1-1/2"	1"	106	280	256	228	168	58	48	65	95	120	19	10	4	Ø14	6.5
FTKR2225-50A-Ø26, Ø32	26,32	1-1/2"	1"	106	280	256	228	168	58	48	65	95	120	19	10	4	Ø14	6.5
FTKR2205-65A-32A	1-1/4"	2"	1-1/2"	127	336	306	271	194	64	60	80	110	136	20	12	4	Ø14	11.7
FTKR2225-65A-Ø32, Ø40, Ø48	32,40,48	2"	1-1/2"	127	336	306	271	194	64	60	80	110	136	20	12	4	Ø14	11.7
FTKR2205-80A-40A	1-1/2"	2"	1-1/2"	145	327	299	275	202	65	70	90	125	154	20	12	6	Ø14	13.6
FTKR2225-80A-Ø48	48	2"	1-1/2"	145	327	299	275	202	65	70	90	125	154	20	12	6	Ø14	13.6

# 2200 Series Rotary Joints



### Operating Condition

- Size Range : 6A~80A (1/8"~3")
- Max. Pressure : 10kg/cm<sup>2</sup> (150PSI)
- Max. Rotation Speed :
  - 6A~25A (1/8"~1") : 1000RPM
  - 32A~40A (1.1/4"~1.1/2") : 700RPM
  - 50A~80A (2"~3") : 500RPM
- Max. Temperature : 100°C (210°F)
- Media : Water, Air, Gas, Oil
- \* Avoid max. pressure at max. rpm operation

### Features

- Balanced Seal Type
  - Enables High speed rotation at High pressure
  - Low friction
- Stainless steel shaft and springs.
- Silicon-Carbide Sealing for KRS model
  - Extended running hours than KR Model
  - Protection against media contamination by rust, scale, chips & other harmful abrasives.

### [SINGLE]

#### ▼ FTKR2211 / FTKR2212

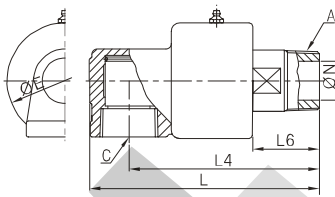

#### ▼ FTKR2215

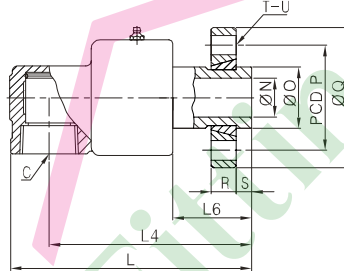

[unit : mm]

MODEL NO.		A	C	E	L	L4	L6	N	X	Wt
PT [RH]	PT [LH]	(PT)	(PT)							(kg)
FTKR2211-6A	FTKR2212-6A	1/8"	1/4"	40	78	67	23	5	14	0.5
FTKR2211-8A	FTKR2212-8A	1/4"	1/4"	40	78	67	23	5	14	0.5
FTKR2211-10A	FTKR2212-10A	3/8"	3/8"	40	93	76	26	9.5	17	0.4
FTKR2211-15A	FTKR2212-15A	1/2"	1/2"	51	114	96.5	35	13	21	0.65
FTKR2211-20A	FTKR2212-20A	3/4"	3/4"	56	122	101.5	38	17	26	0.83
FTKR2211-25A	FTKR2212-25A	1"	1"	66	131	108.5	38	22	30	1.2
FTKR2211-32A	FTKR2212-32A	1-1/4"	1-1/2"	88	173	138	46	30	46	2.7
FTKR2211-40A	FTKR2212-40A	1-1/2"	1-1/2"	88	173	138	46	35	46	2.6
FTKR2211-50A	FTKR2212-50A	2"	2"	106	206	168	58	48	60	5.0
FTKR2211-65A	FTKR2212-65A	2-1/2"	2-1/2"	127	240	191	64	60	75	9.0
FTKR2211-80A	FTKR2212-80A	3"	3"	145	278	224	75	70	89	14.5

MODEL NO.	C	E	L	L4	L6	N	O	P	Q	R	S	T	U	Wt
FLANGE	(PT)													(kg)
FTKR2215-15A	1/2"	51	114	96.5	35	13	25	45	62	11	8	4	Ø9	0.9
FTKR2215-20A	3/4"	56	126	105.5	42	17	30	54	74	13	8	4	Ø11	1.2
FTKR2215-25A	1"	66	138	115.5	45	22	35	60	80	14	9	4	Ø11	1.6
FTKR2215-40A	1-1/2"	88	182	147	55	35	50	75	96	16	9	4	Ø11	3.2
FTKR2215-50A	2"	106	206	168	58	48	65	95	120	19	10	4	Ø14	5.8
FTKR2215-65A	2-1/2"	127	240	191	64	60	80	110	136	20	12	4	Ø14	10.8
FTKR2215-80A	3"	145	268	214	65	70	90	125	154	20	12	6	Ø14	15.0

